

G:\2018 PROJECTS\18C17016.00 BEAVER CREEK\03-SE PRODUCTS\08-CAD\DRAWINGS\04-REPORTS\PRELIMINARY ENGINEERING REPORT\PER.DWG

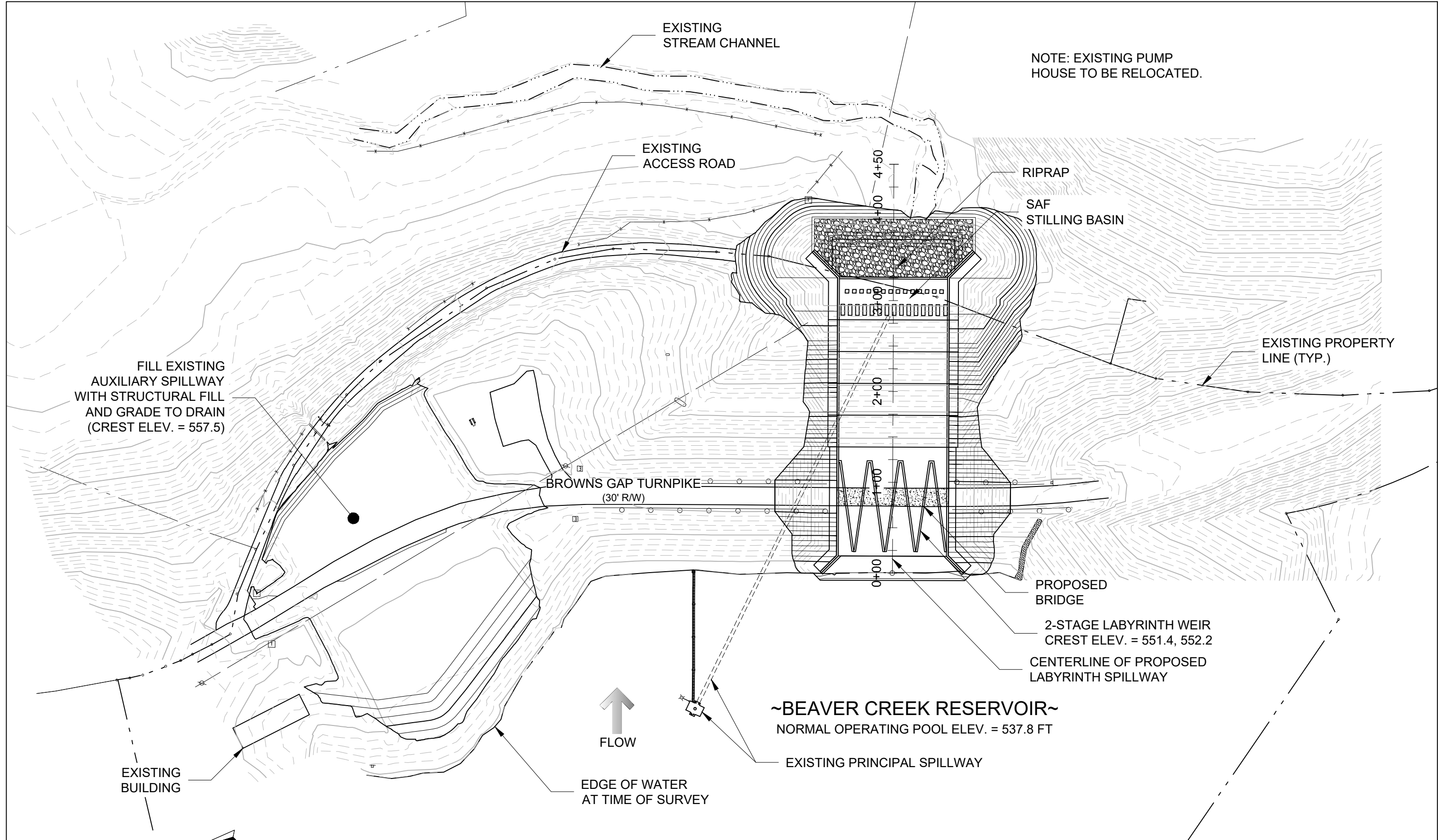

NOTE: EXISTING PUMP HOUSE TO BE RELOCATED.

FILL EXISTING AUXILIARY SPILLWAY WITH STRUCTURAL FILL AND GRADE TO DRAIN (CREST ELEV. = 557.5)

BROWNS GAP TURNPIKE (30' R/W)

RIPRAP SAF STILLING BASIN

EXISTING PROPERTY LINE (TYP.)

PROPOSED BRIDGE

2-STAGE LABYRINTH WEIR CREST ELEV. = 551.4, 552.2

CENTERLINE OF PROPOSED LABYRINTH SPILLWAY

~BEAVER CREEK RESERVOIR~  
NORMAL OPERATING POOL ELEV. = 537.8 FT



EXISTING PRINCIPAL SPILLWAY

EXISTING BUILDING

EDGE OF WATER AT TIME OF SURVEY

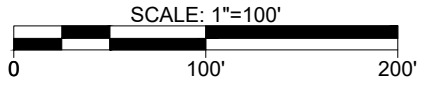
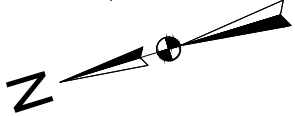

BEAVER CREEK DAM  
ALBEMARLE COUNTY, VIRGINIA  
PROJECT NO. 18C17016.00

PROPOSED SPILLWAY  
3.5-CYCLE LABYRINTH SPILLWAY  
CONCEPTUAL SITE PLAN

C:\2018 PROJECTS\18C17016.00 BEAVER CREEK\03-SE PRODUCTS\08-CAD\DRAWINGS\04-REPORTS\PRELIMINARY ENGINEERING REPORT\PER.DWG

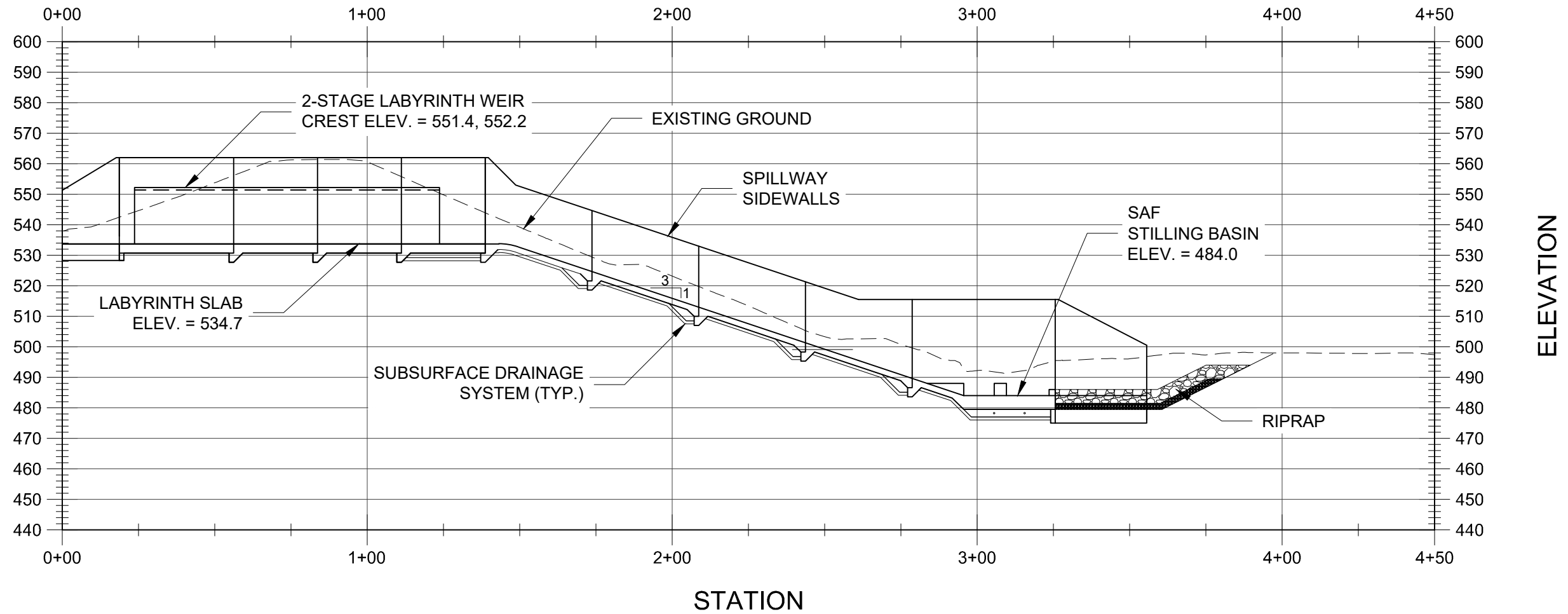

### CONCEPTUAL SPILLWAY PROFILE

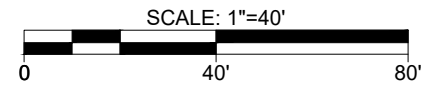

BEAVER CREEK DAM  
ALBEMARLE COUNTY, VIRGINIA  
PROJECT NO. 18C17016.00

PROPOSED SPILLWAY  
3.5-CYCLE LABYRINTH SPILLWAY  
CONCEPTUAL PROFILE